

Short stroke cylinder, Series KHZ

Ø 12–63 mm, double-acting

Rexroth
Bosch Group



Technical Data

Type	Piston cylinder	
Working pressure	1 ... 10 bar (15 ... 145 psi)	
Ambient temperature range	-25 °C to +80 °C (-13 °F to +176 °F)	
Medium	Compressed air	ISO 8573-1:2001, class 6-4-3 or lower*
Materials	Piston rod Body	Stainless steel Anodized aluminum profile

Application area

Suitable for clamping tasks
For Ø 80 and 100, elastic impact cushioning on the piston

* Particle size ≤ 5 µm, dew point ≤ 3 °C, oil content ≤ 1 mg/m³



Technical information

Piston Ø	[mm]	12	16	20	25	32	40	50	63	80	100	
Piston force,	Pushing force	[N]	58	106	164	258	422	665	1035	1752	2656	4145
		(lbf)	(13)	(23.8)	(36.9)	(58)	(94.9)	(147)	(233)	(394)	(597)	(932)
theoretical at 6 bar (87 psi)	Pulling force	[N]	45	91	137	228	364	560	871	1584	2397	3886
		(lbf)	(10.1)	(20.5)	(30.8)	(51.3)	(81.8)	(126)	(196)	(356)	(539)	(874)
Weight	at 0 mm stroke	[kg]	0,036	0,063	0,082	0,164	0,195	0,285	0,388	0,636	1,222	2,385
		(lbs)	(0.079)	(0.139)	(0.180)	(0.362)	(0.430)	(0.628)	(0.855)	(1.402)	(2.694)	(5.258)
	at 5 mm stroke	[kg]	0,042	0,073	0,095	0,181	0,222	0,311	0,423	0,681	1,332	2,508
		(lbs)	(0.093)	(0.161)	(0.209)	(0.399)	(0.489)	(0.686)	(0.933)	(1.501)	(2.937)	(5.529)

Part no.

Piston Ø [mm]	12	16	20	25	32
Piston rod thread	-	M5	M5	M5	M5
Threaded ports	M5	M5	M5	G1/8	G1/8
Stroke					
5	0822010500	0822010510	0822010520	0822010530	0822010540
10	0822010501	0822010511	0822010521	0822010531	0822010541
15	0822010502	0822010512	0822010522	0822010532	0822010542
20	0822010503	0822010513	0822010523	0822010533	0822010543
25	0822010504	0822010514	0822010524	0822010534	0822010544
30	0822010505	0822010515	0822010525	0822010535	0822010545
40	0822010506	0822010516	0822010526	0822010536	0822010546
50	-	-	0822010527	0822010537	0822010547
Piston Ø [mm]	40	50	63		
Piston rod thread	M6	M8	M8		
Threaded ports	G1/8	G1/8	G1/8		
Stroke					
5	0822010550	-	0822010570		
10	0822010551	0822010561	0822010571		
15	0822010552	0822010562	0822010572		
20	0822010553	0822010563	0822010573		
25	0822010554	0822010564	0822010574		
30	0822010555	0822010565	0822010575		
40	0822010556	0822010566	0822010576		
50	0822010557	0822010567	0822010577		

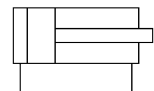

Accessories (to be ordered separately)

Accessory	Type	12	16	20	25	32
	Piston Ø [mm]	12	16	20	25	32
	Spare parts	1827009706	1827009707	1827009708	1827009709	1827009710
	Piston Ø [mm]	40	50	63	80	100
	Spare parts	1827009711	1827009712	1827009713	1827009714	1827009715

Short stroke cylinder, Series KHZ

Ø 12–63 mm, double-acting

Rexroth
Bosch Group

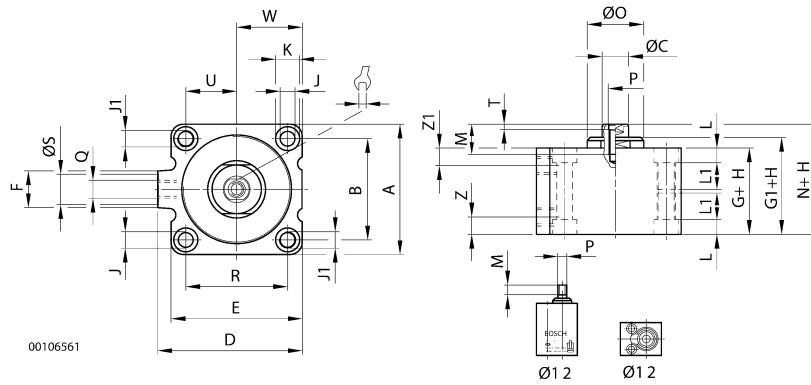

H = Stroke

Piston Ø. [mm]	H	A JS15	B ±0,2	C f8	D JS15	E JS15	F	G ±0,2	G1 -1	Z	Z1	J H13	J1
12	5 - 40	20	13	6	-	25	-	21	-	5	8,5	-	M4
16	5 - 40	28	20	8	33	28	11,5	25	-	6	11,3	3,65	M4
20	5 - 50	32	22	10	37	32	11	24,5	-	5	7	4,6	M5
25	5 - 50	37	26	10	47,5	39	18	31	34,5	9	11	4,6	M5
32	5 - 50	45	32	12	56	48,5	18,5	33	38,5	8,5	12	5,5	M6
40	5 - 50	54,5	40	12	62,5	54,5	18,5	33	38	9	11	5,5	M6
50	10 - 50	64	50	16	72	64	19	32,5	38,5	8,5	11	7,3	M8
63	10 - 50	80	62	16	88	80	23	35,5	42	8,5	12	9	M10

Piston Ø [mm]	H	K H13	L +0,4	L1 min.	M +1	N ±1	O	P	Q	R ±0,2	S	SW h13	T +0,5	U	W ±0,2
12	5 - 40	6	3,4	9	8	31	-	M5	M5	-	8	-	-	9	9
16	5 - 40	6	3,4	9	10	31	-	M5	M5	20	8	7	2	10	14
20	5 - 50	7,5	4,6	9	10	34	-	M5	M5	22	8	8	2	11	16
25	5 - 50	8	4,6	9	10	42,5	20	M5	G 1/8	28	15	8	2	14	19,5
32	5 - 50	10	5,7	11	14,5	45,5	22	M6	G 1/8	36	15	10	2,5	18	24
40	5 - 50	10	5,7	11	15	48	30	M6	G 1/8	40	15	10	2,5	20	27,3
50	10 - 50	11	6,8	13	17,5	49,5	35	M8	G 1/8	50	15	13	3,5	25	33
63	10 - 50	15	9	16	17,5	52,5	35	M8	G 1/8	62	15	13	3,5	31	40